

WS1/WS2-K

Wireless Access Kit

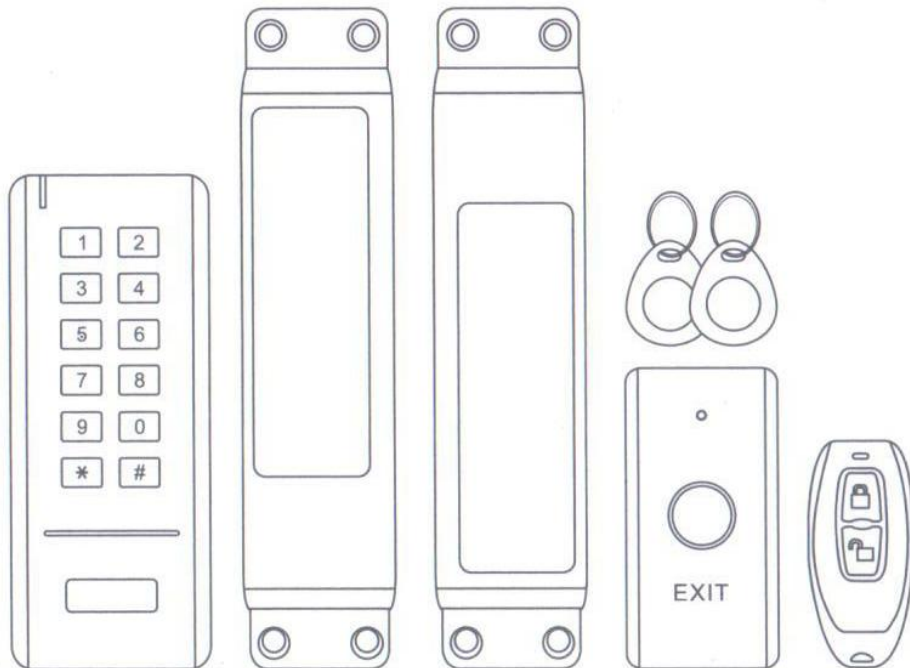

User Manual

Simplified Instruction	
Function description	Operation
Enter the Program Mode	* (Master Code) # (123456 is the factory default master code)
Change the Master Code IMPORTANT NOTE: Please remember the New Master Code as it can't be reset to default if forgotten	0 (New Code) # (Repeat New Code) # (code: 6 digits)
Add PIN User	1 (User ID) # (PIN) # (Repeat PIN) #
Add Card User	1 (User ID) # (Read Card)
Delete User	2 (User ID) # 2 (Read Card)
Exit from the Program Mode	*
How to release the door	
PIN Access	PIN #
Card Access	# (Read Card)
By Remote Transmitter	Press
By Exit Button	Press the button
Lock Immediately	
By keypad	Press "0 #"
By Remote Transmitter	Press

20240301_V2

INTRODUCTION

WS1/WS2-K is a set of complete wireless access kit for home/office use. It consists of a Wireless Keypad, a Wireless Bolt Lock (suitable for metal/wooden door and framed glass door), a Wireless Exit Button, 1 Remote Transmitter and 2 Keyfobs. Super strong 3M stickers provide simple installation way.

Major Parts

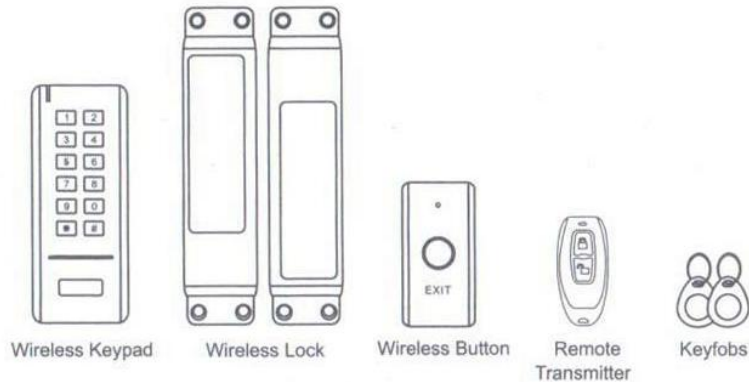

Battery type:

Wireless Keypad: 3 units of AAA batteries

Wireless Lock: 2 units of AA batteries

Wireless Exit Button: 1 unit of 2032 Lithium battery (Battery is already contained in the equipment)

Remote Transmitter: 1 unit of 2032 Lithium battery (Battery is already contained in the equipment)

Because of ultra low power consumption, the keypad, exit button and remote transmitters can work as long as one year (bases on 30 times/day); the open times of the lock is over 16,000 times (can work about one year bases on 40 times/day). It will remind people to replace batteries intelligently if low battery.

How to release the door ?

(All parts are paired already, and the keyfobs are added in the device. Users can operate it directly.)



3 versions for option:

WS1/WS2-K: including a wireless keypad, a wireless lock, a wireless button, 1 remote transmitter and 2 keyfobs

WS1-A/WS2-K: including a wireless keypad, a wireless lock, a wireless button and 2 keyfobs

(Note: WS2-K is with IP65 metal keypad)

Features:

- All wireless, no need wires any more
- Easy for installation and operation
- Open times: 16,000 times for lock, 10,000 times for keypad
- 433MHz Rolling Code technology
- Ultra low power consumption
- With two Remote Transmitters
- 100 PIN/card users
- 4-6 digits PIN, 125KHz EM card / 13.56MHz Mifare card (Optional)
- Communication distance: 15~20m Max
- Support Authorized Users

Specifications:

User Capacity PIN Length Card Type	100 (PIN/Card) 4-6 Digits 125KHz EM / 13.56MHz Mifare card (optional)
Operating Voltage Wireless Keypad Wireless Lock Wireless Exit Button Remote Transmitter	3 units of AAA batteries 2 units of AA batteries 1 unit of 2032 Lithium battery 1 unit of 2032 Lithium battery
Idle Current	All items ≤10uA
Working Current Wireless Keypad Wireless Lock Wireless Exit Button Remote Transmitter	≤50mA ≤42mA ≤3mA ≤3mA
Communication Frequency	433MHz
Communication Distance	15~20m Max
Environment Operating Temperature Operating Humidity	-20 °C~+60 °C(-4 °F~+140 °F) 0%~86%RH
Physical Wireless Lock Wireless Keypad Others	Zinc-Alloy ABS / Zinc-Alloy (IP65) ABS Shell
Dimensions Wireless Keypad Wireless Lock Wireless Exit Button Remote Transmitter	ABS: L135XW54XH19(mm) Metal: L148XW56XH22.5(mm) L169×W40×D25(mm) L83×W40×D16(mm) L62×W27×D11.5(mm)

Unit Weight Wireless Keypad Wireless Lock Wireless Exit Button Remote Transmitter	ABS: 570g / Metal: 765g ABS: 90g / Metal: 285g 400g 30g 25g/pc
--	---

INSTALLATION

Wireless Keypad: Install by 3M stickers or screws

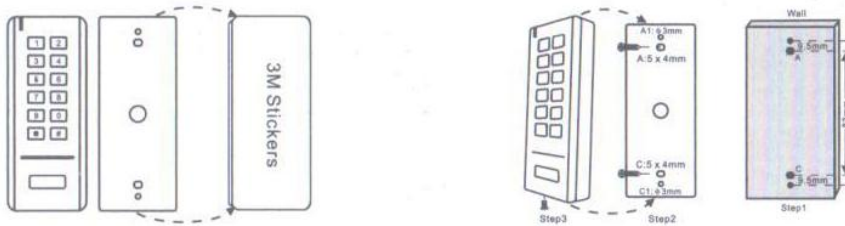

Wireless Lock: Install by screws

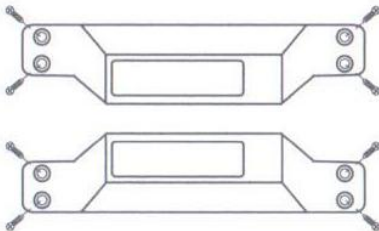

Wireless exit button: Install by 3M stickers

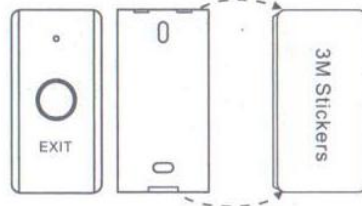

How to release the door ?

Programming Step	Keystroke Combination
PIN User Access	(PIN) #
Card User Access (Keyfobs in the package are added already)	# (Read Card)
By Remote Transmitter	Press
By Exit Button	Press the button

KEYPAD PROGRAMMING

Enter and Exit Program Mode

Programming Step	Keystroke Combination
1. Enter Program Mode	* (Master Code) # (Factory default is 123456)
2. Exit	*

Set Master Code

Please do remember your Master Code because the Master Code can't be reset if forget it.

Programming Step	Keystroke Combination
1. Enter Program Mode	* (Master Code) #
2. Update Master Code	0 (New Master Code) # (Repeat New Master Code) # Master code is any 6 digits
3. Exit	*

Add PIN Users

User ID: 1~98 Authorized User ID: 99,100

PIN length: 4~6 digits

Programming Step	Keystroke Combination
1. Enter Program Mode	* (Master Code) #
2. Add PIN	1 (User ID) # (PIN) # (Repeat PIN) # User ID is 6~98(5 keyfobs already added with User ID 1~5)
3. Exit	*

Add Card Users (The 5 units keyfobs in the package are added already)

User ID: 1~98

Card type: 125 KHz EM Card / 13.56MHz Mifare Card (Optional)

Programming Step	Keystroke Combination
1. Enter Program Mode	* (Master Code) #
2. Add Card: Select Specific ID (Allows Master to define a Specific User ID to associate the card)	1 (User ID) # (Read Card) User ID is 6~98(5 keyfobs already added with User ID 1~5)
3. Exit	*

Set Authorized User (PIN only)

Authorized User is user can set the permissions of ALL users.

After enabling Authorized User, all valid users cannot open the door, only after disabling Authorized User, all enrolled users can open the door as normal.

Authorized User ID: 99,100

Programming Step	Keystroke Combination
1. Enter Program Mode	* (Master Code) #
2. Add Authorized User	1 (99 or 100) # (PIN) # (Repeat PIN) # Authorized PIN is any 6 digits
2. Enable Authorized User	(Authorized PIN) 99 #
OR	
2. Disable Authorized User	(Authorized PIN) 00 #
3. Exit	*

Delete Users

Programming Step	Keystroke Combination
1. Enter Program Mode	* (Master Code) #
2. Delete by User ID OR 2. Delete by Card OR 2. Delete ALL users	2 (User ID) # The users can be deleted continuously. 2 (Read Card) 2 (Master Code) #
3. Exit	*

Set Access Mode

Programming Step	Keystroke Combination
1. Enter Program Mode	* (Master Code) #
2. PIN Access OR 2. Card Access OR 2. PIN or Card Access	3 0 # 3 1 # 3 2 # (factory default)
3. Exit	*

Set Auto-Lock / Non-Auto-Lock

Programming Step	Keystroke Combination
1. Enter Program Mode	* (Master Code) #
2. Non-Auto-Lock OR 2. Auto-Lock	4 0 # 4 9 # (Auto lock after 5 seconds)
3. Exit	*

Set Buzzer

Programming Step	Keystroke Combination
1. Enter Program Mode	* (Master Code) #
2. Buzzer OFF OR 2. Buzzer ON	5 0 # 5 1 # (factory default)
3. Exit	*

Lock Immediately

The Wireless Lock will be locked automatically around 5 seconds after we open it. If we want to lock it faster, please press "0 #" on the Keypad, or press  on the Remote Transmitter, it will lock immediately.

Pair Wireless Keypad / Wireless Exit Button / Remote Transmitter with Wireless Lock
(They are already paired when out of factory, if no problem, the users do not need to do this operation in using.)

Note: 1. The Wireless Lock can pair 4 parts (Keypad or Remote Transmitter or Exit Button) maximum.
2. When pairing, all parts must be paired, then exit pairing mode. If need adding one more part, you still need to pair all parts again.

Step 1: Enter pairing mode

Open the battery cover of Wireless Lock, press the small round button on the PCB, hold it for 5 seconds, until hearing two beeps, that means in the pairing status.

Step 2: Pairing Wireless Keypad

Press the button "0 #" on the keypad, there will be one beep from Lock, that means pairing successfully.

Step 3: Pairing Wireless Exit Button

Press the exit button, until hearing one beep from Lock, that means pairing successfully.

Step 4: Pairing Remote Transmitter

Press any button on the Remote Transmitter, until hearing one beep from Lock, that means pairing successfully.

Step 5: Exit pairing mode

After pairing all parts, press the small round button in the Wireless Lock again, until hearing one beep, that means exit pairing successfully. Or it will exit pairing mode automatically 15 seconds later if there is no operation.

